

# SWANSON SQUARE FOR LEASE: COMMERCIAL/FLEX SPACE

20 & 38 Jackson St, 21 Wolf Street, Philadelphia PA 19148

EQUITY RETAIL BROKERS



## 20 Jackson St

1st Floor: Leased & Lease Pending  
2nd Floor: 24,900 SF Available

## 38 Jackson St

Lower Level: Fully Leased  
1st Floor: Fully Leased  
2nd Floor: 2,100 SF & 8,800 SF Available

## 21 Wolf St

Lower Level: 9,800 SF Available  
1st Floor: 11,508 SF Available  
2nd Floor: Fully Leased



## PROPERTY FEATURES & DETAILS

- Adjacent to newest Amazon Distribution Center
- Across the street from a potential retail development
- Multiple size and use options
- On street parking readily available

- Freight Elevators
- Zoning: I2
- Can consider all office/commercial/retail uses

### Neighboring Tenants



## CONTACT

CONOR TUNNO

ctunno@equityretailbrokers.com

CELL 484.796.1201



# SWANSON SQUARE FOR LEASE: COMMERCIAL/FLEX SPACE

20 & 38 Jackson St, 21 Wolf Street, Philadelphia PA 19148

EQUITY RETAIL BROKERS



The right space. The right move.



Information concerning this offering is from sources deemed reliable but no warranty is made to the accuracy thereof and it is submitted subject to errors, omissions, changes of price or other conditions, prior to sale or lease or withdrawal without notice. Equity Retail Brokers is licensed in PA, NJ, & DE. Conor Tuno & Steve Jeffries are licensed salespersons in PA.

03/25



# SWANSON SQUARE FOR LEASE: COMMERCIAL/FLEX SPACE

20 & 38 Jackson St, 21 Wolf Street, Philadelphia PA 19148

EQUITY RETAIL BROKERS

## 20 Jackson St



### 1st Floor

### 2nd Floor

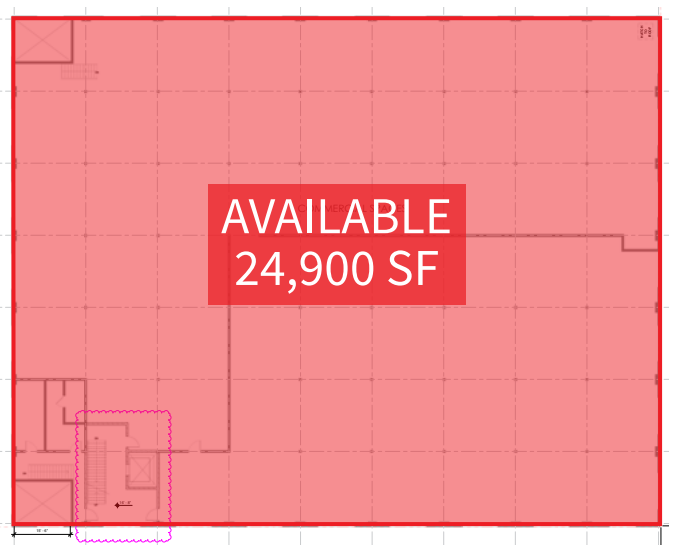
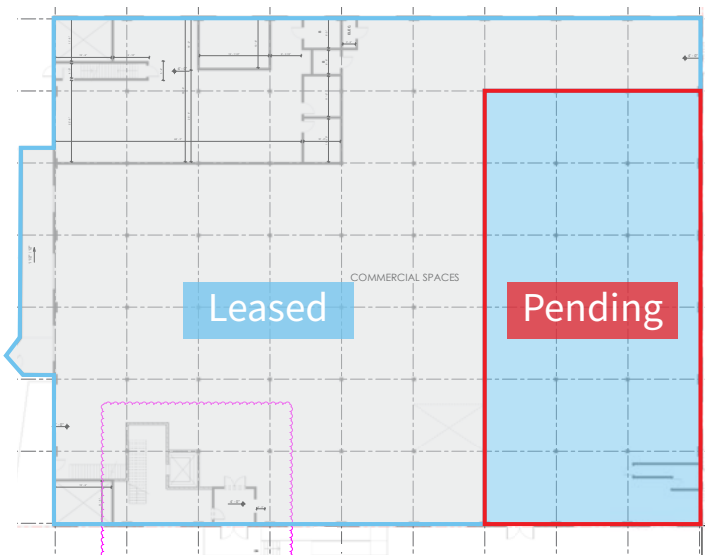

# SWANSON SQUARE FOR LEASE: COMMERCIAL/FLEX SPACE

20 & 38 Jackson St, 21 Wolf Street, Philadelphia PA 19148

EQUITY RETAIL BROKERS

## 38 Jackson St



1st Floor

2nd Floor

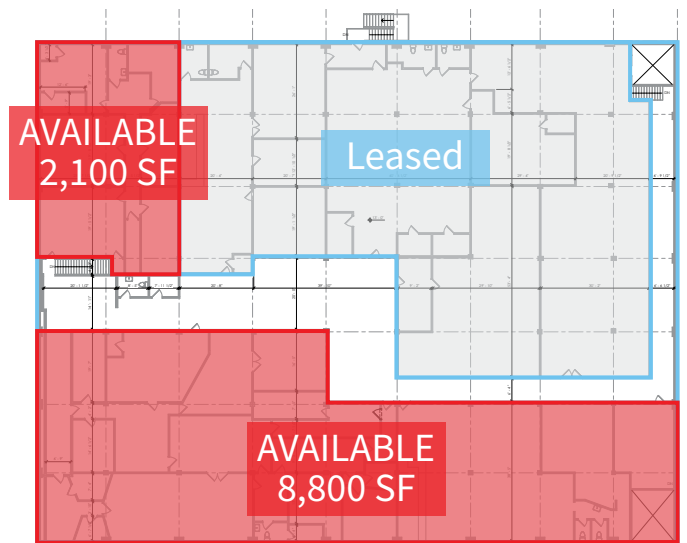
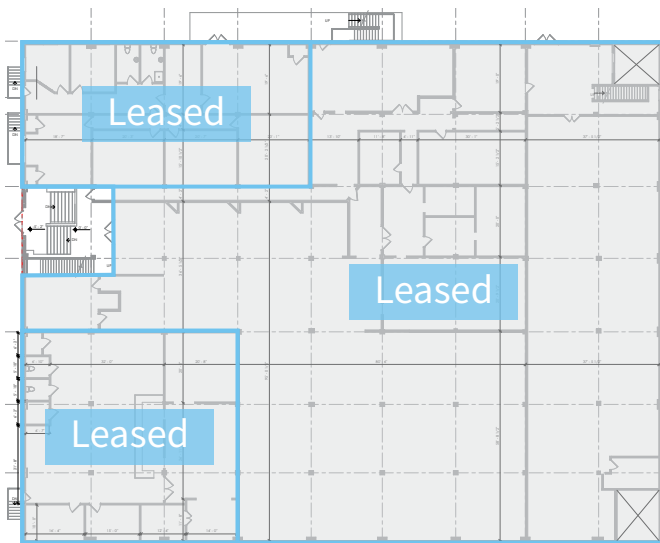



# SWANSON SQUARE FOR LEASE: COMMERCIAL/FLEX SPACE

20 & 38 Jackson St, 21 Wolf Street, Philadelphia PA 19148

EQUITY RETAIL BROKERS

## 21 Wolf St



### Lower Level

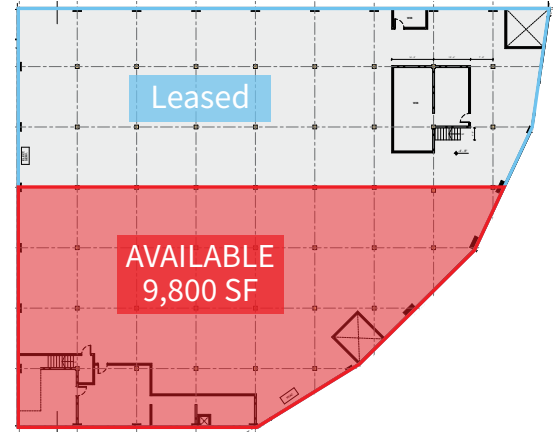

### 1st Floor

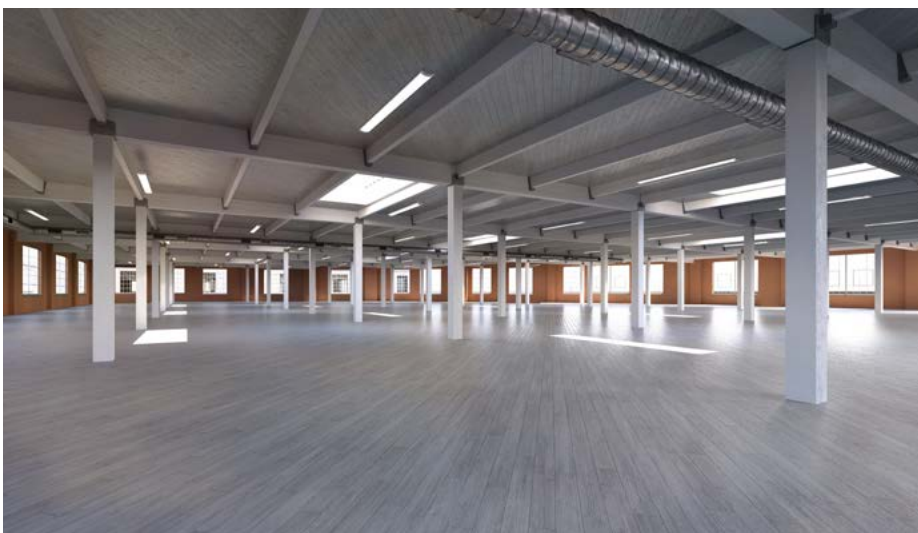
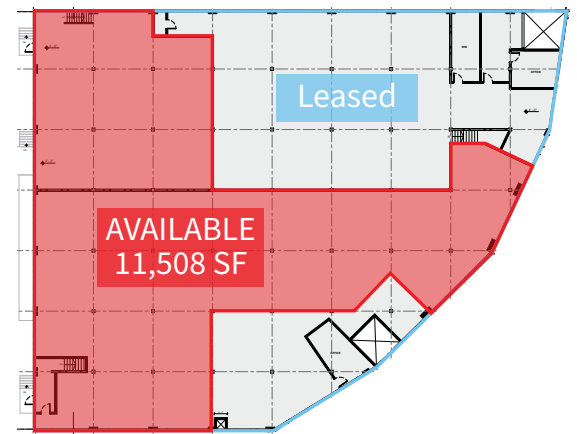

### 2nd Floor

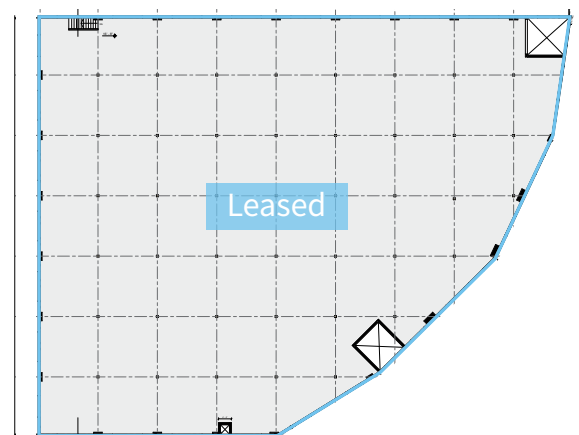



# SWANSON SQUARE FOR LEASE: COMMERCIAL/FLEX SPACE

20 & 38 Jackson St, 21 Wolf Street, Philadelphia PA 19148

EQUITY RETAIL BROKERS

## LOCATION AERIAL



## Demographic Overview (0.5, 1, 2-mile radius)

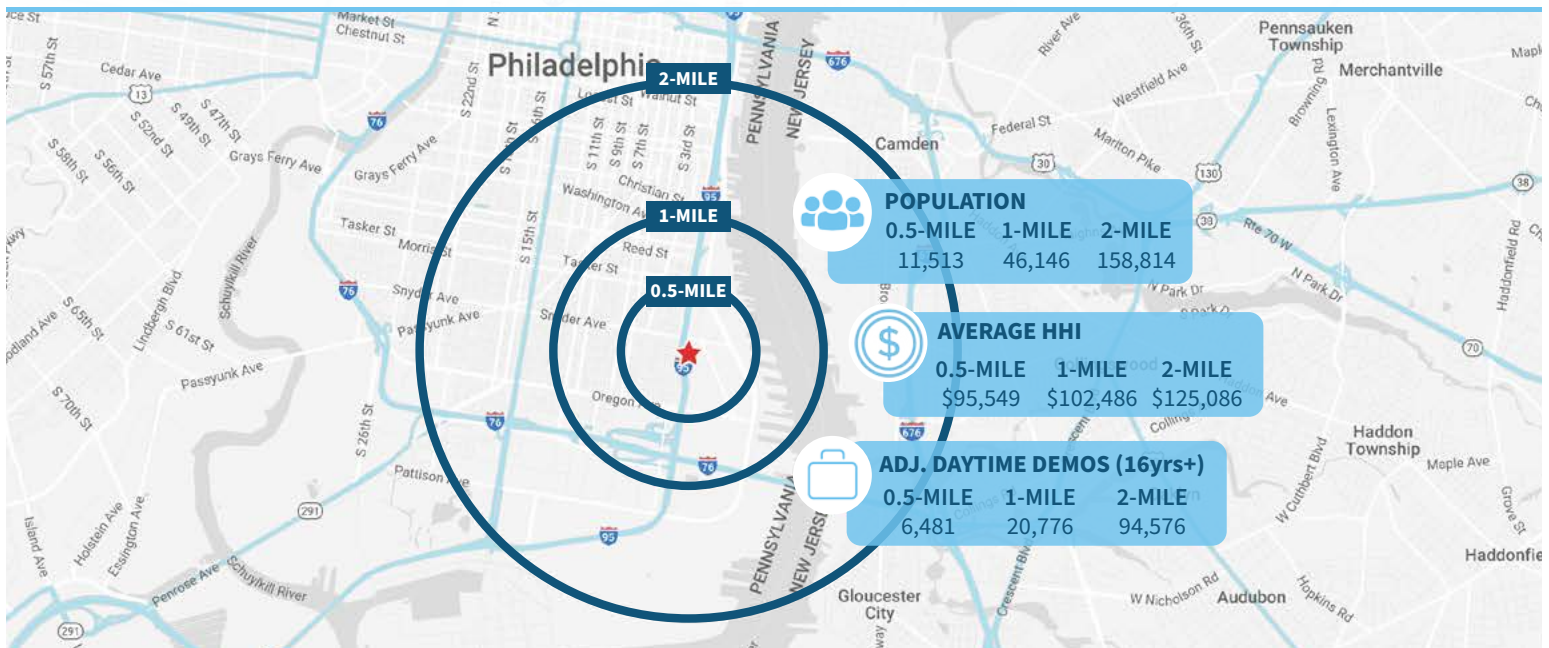



# MARKET AERIAL

Swanson Square | Philadelphia County, PA



Aerial Source: Google Earth Pro & Traffic Count Source: Placer.ai ('23)

Compliments of:

EQUITY RETAIL BROKERS

531 W. Germantown Pike, Ste 103 ■ Plymouth Meeting, PA 19462  
610.645.7700 ■ www.equityretailbrokers.com

03/25